

Turnitin: Plagiarism Detection in Canvas

Turnitin is a Canvas-integrated plagiarism detection tool.

You can find excellent documentation on how to use the tool at the [Turnitin website](#), but here is a brief guide to getting started.

Establish a Turnitin account

The first time you integrate Turnitin into one of your Canvas courses, the system will establish your user account at [turnitin.com](#). If you try to sign into [turnitin.com](#) prior to that, you'll have to create your user account first.

On the login screen, select **Forgot your password?** Then enter your email address and check your inbox for a password reset email.

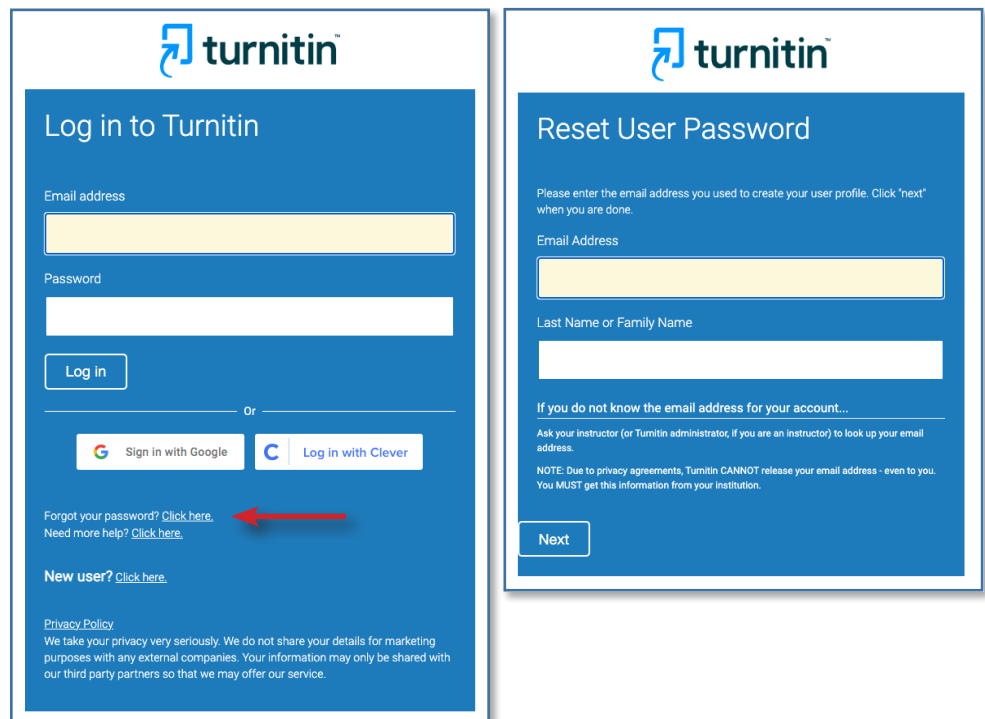

The left screenshot shows the Turnitin login page. It features the Turnitin logo at the top, followed by the heading "Log in to Turnitin". Below this are two input fields: "Email address" and "Password". A "Log in" button is positioned below the password field. Underneath, there is an "Or" separator and two social login options: "Sign in with Google" and "Log in with Clever". At the bottom of the login section, there are three links: "Forgot your password? Click here.", "Need more help? Click here.", and "New user? Click here.". A red arrow points to the "Forgot your password? Click here." link. A "Privacy Policy" link is located at the very bottom of the page.

The right screenshot shows the "Reset User Password" page. It features the Turnitin logo at the top, followed by the heading "Reset User Password". Below this is a paragraph of instructions: "Please enter the email address you used to create your user profile. Click 'next' when you are done." There are two input fields: "Email Address" and "Last Name or Family Name". Below these fields is a "Next" button. At the bottom of the page, there is a "NOTE: Due to privacy agreements, Turnitin CANNOT release your email address - even to you. You MUST get this information from your institution."

Information Technology Services

www.odu.edu/its

(757) 683-3192

itshelp@odu.edu

1100 Monarch Hall

[oduits](#) [odu_its](#)

Update your profile

Once you log into [turnitin.com](#), **update your site profile**. To access your profile, select your name at the top of the screen. There are several settings there that impact how the tools work and how feedback is provided. You'll especially want to set your default user type, default submission type, and the default file type.

Remember: You might have multiple roles available in your Turnitin user account. Make sure to select the correct one for the work you are doing.

Submissions

Important: All work that is submitted directly through the Turnitin site (turnitin.com) are NOT replicated back to Canvas. Even if an assignment or assessment has been created and is available in Canvas, assignments that are submitted directly through turnitin.com will not replicate back to Canvas.

Bulk uploads

Once you have created a Turnitin assignment or assessment in Canvas, you can go to turnitin.com to upload multiple documents at once for plagiarism review.

1. Click **User Info**, then look under Account Settings for **Activate quick submit**.

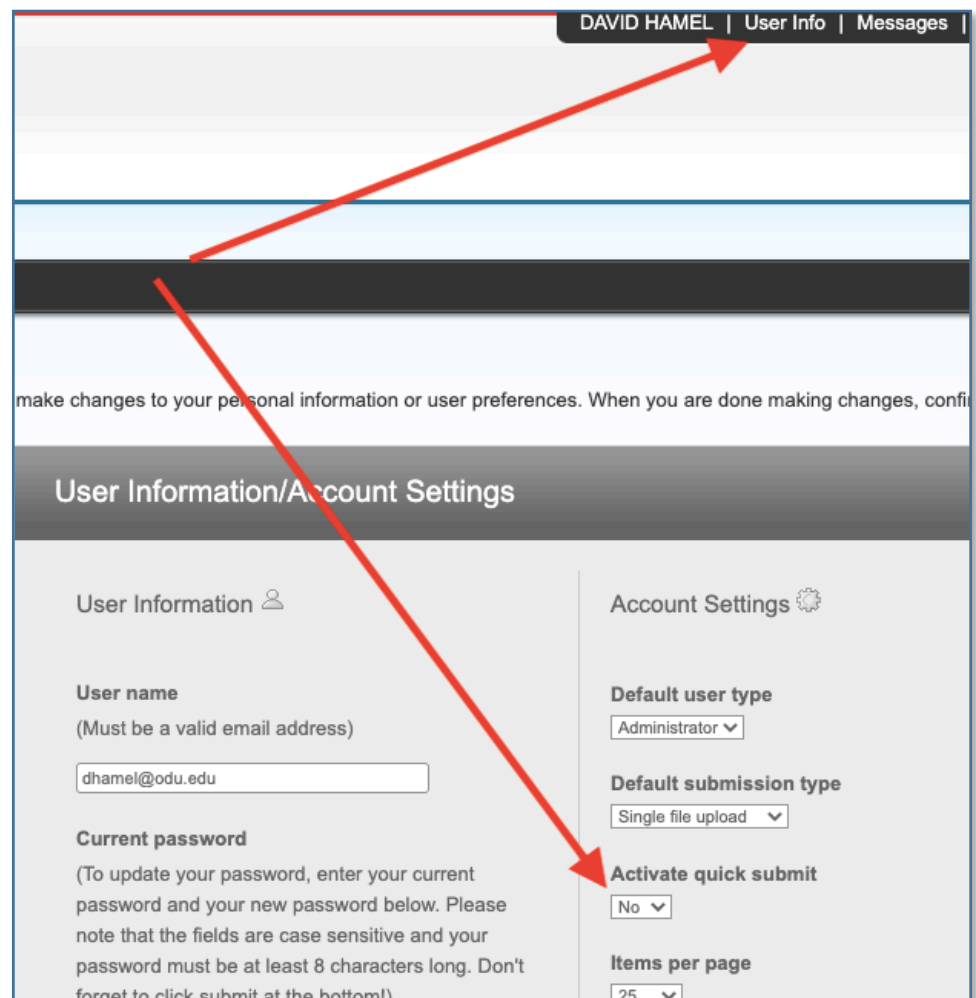

2. Change **Activate quick submit** to **Yes** and hit **Submit**

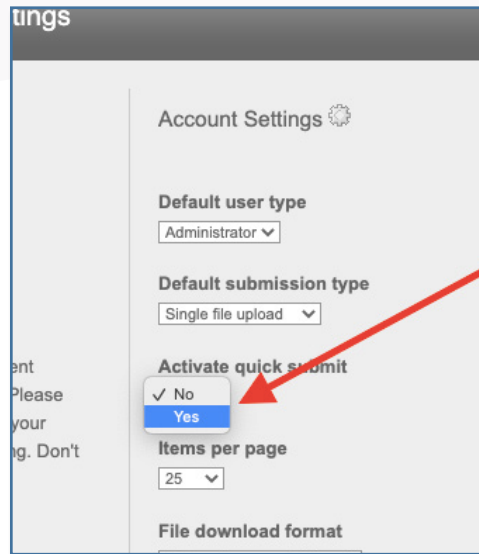

3. Once these settings have been saved, you'll see a new tab at the top of your page called **Quick Submit** where you can upload multiple documents at once.

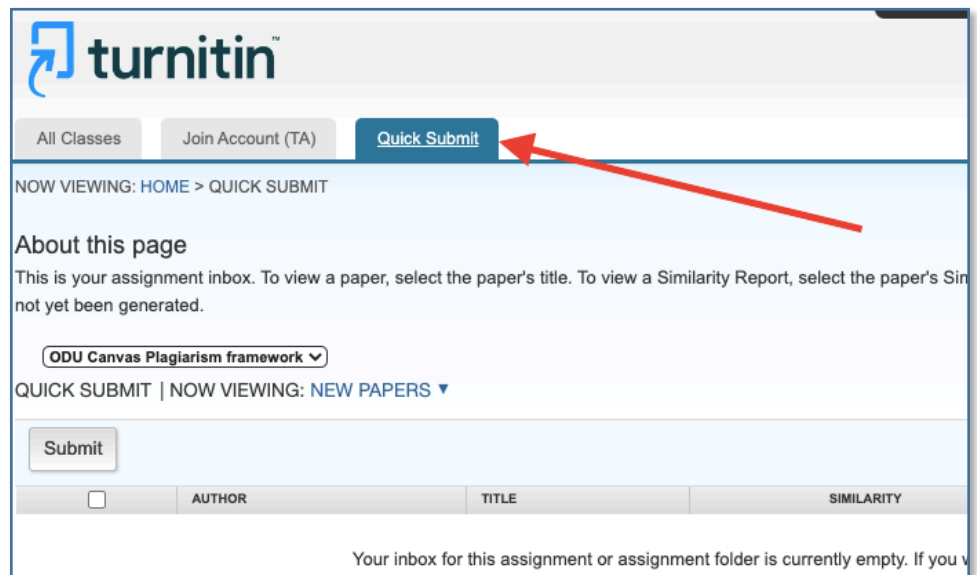

Learn more

Once your profile is set up, learn more about using the site and tools at the Turnitin website:

- help.turnitin.com/feedback-studio/turnitin-website/instructor/quickstart
- help.turnitin.com/feedback-studio/turnitin-website/instructor/making-a-submission/multiple-file-upload-on-behalf-of-a-student

And all documentation for instructors:

- help.turnitin.com/feedback-studio/turnitin-website/instructor/instructor-category